



M1500 / M2000 / M2500 / M3000 / S1800 / S2500 / S3000

Quick Installation Guide - Trucks with sleeper

Detailed Installation Manual available at www.tundrainverters.com / Support section

NOTE

This inverter is designed to be installed and used in a Class 8 truck with sleeper.

It can be installed in other types of vehicles or in a stand-alone installation, but no guarantee of operation or compatibility is offered, and the risks are entirely at the expense of the buyer.

1

Safety instructions

SAFETY FIRST

A power inverter is an energy conversion device that must be taken seriously, and that must be installed carefully by a qualified technician. Do not carry out the tasks of an electrician if you don't have the knowledge and skills required.

DANGER

HIGH VOLTAGE ⚡

An inverter produces an electrical current similar to that produced by conventional power grids. This electrical current is powerful enough to injure or kill anyone nearby.

2

Unpack the inverter / Check components



Power inverter



Monitor and surface mount kit



Monitor cable



Rubber insulators



4X Mounting bolts and nuts



2X 12 V input bolts

3

Unpack the installation material / Check components

CM Series / Optional

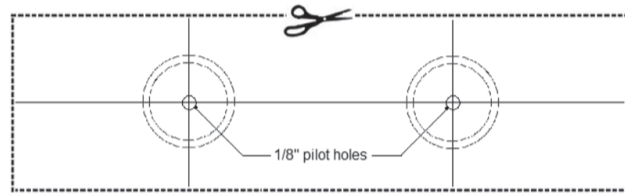

Mounting template

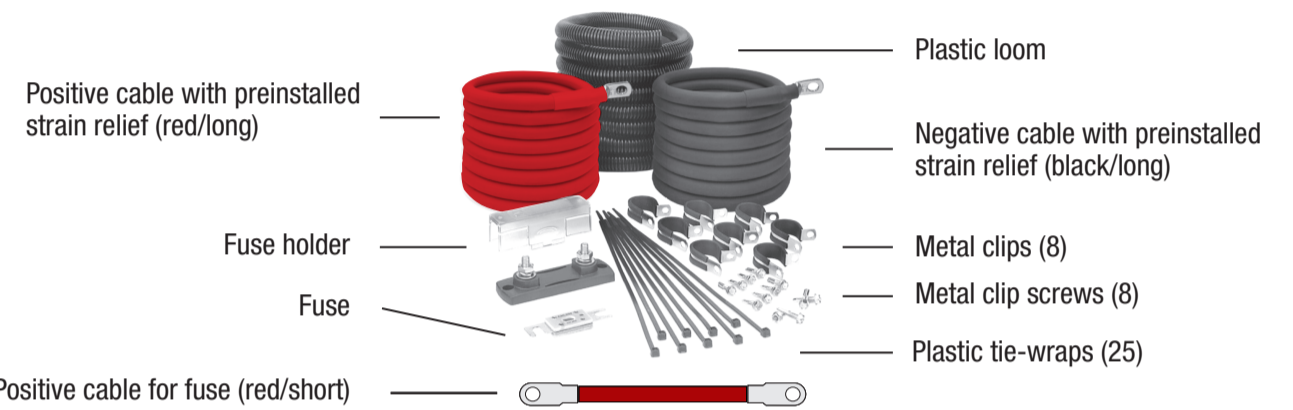

4

Install the inverter

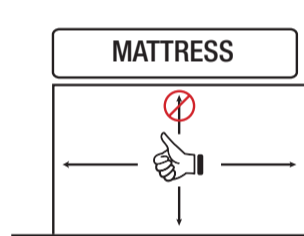

The inverter must be installed in the luggage compartment underneath the bed



Choose a well-ventilated area, away from liquids and heating systems

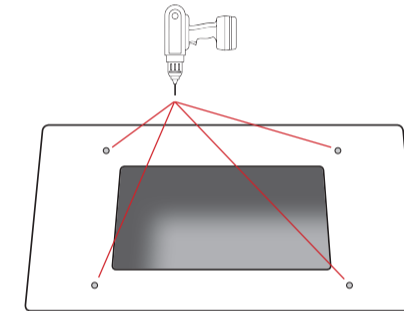

Use the appropriate Tundra drilling template to drill inverter mounting holes. (Sold separately)



Use the bolts included

5

Install the cables

FOR INSTALLATION IN A VEHICLE

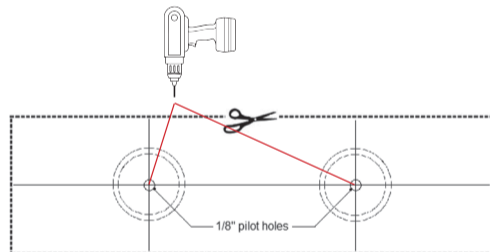

Use the included template to drill the floor



Look out for hoses and cross-members underneath the cab



Install the strain reliefs

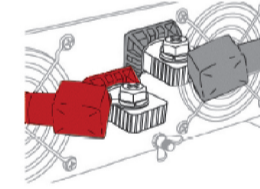

Install the cables and the insulators on the inverter



Respect the polarity

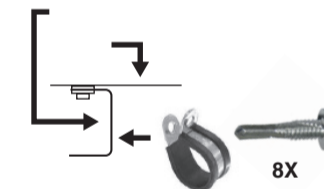

Attach the cables under the cab

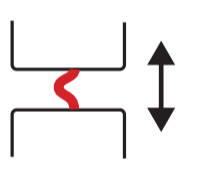

Leave a loop to allow for cab movement

6

Connect cables to the batteries



Assemble the fuse and the two red cables



Do not reverse polarity

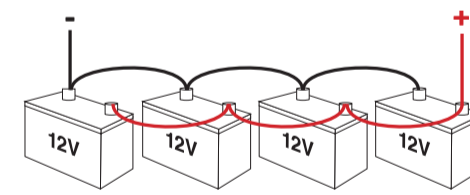

- Connect cables as far apart as possible
- A spark is normal
- Maximum of three terminals per post



Attach the cables with the others on the top of the batteries

7

Install the multidata LCD monitor



SURFACE MOUNT



FLUSH MOUNT

Install the monitor where it is easily accessible

On **S1800**, **S2500** and **S3000** models, the monitor can be detached and relocated up to 19.7 feet (6 m) from the inverter using the included hardware (cover plate + plastic housing kit + 19.7 feet (6 m) of cable).



Route the monitor cable to the desired location

8

120 V connection

IPO Series / Optional

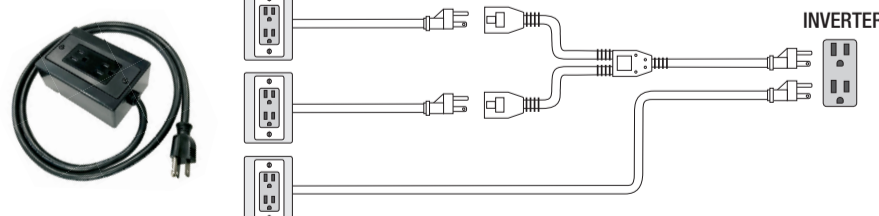

For optimal results, use Tundra IPO In-Cab System of 120 V power outlets. Visit the product section of our web site for more information.

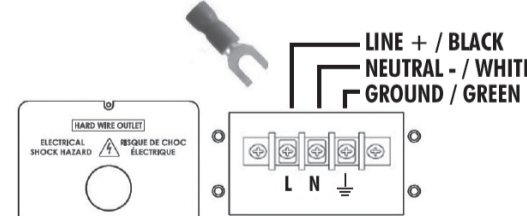

Some models are equipped with a hard-wire fixed connection output for permanent installation to a distribution panel.



AC output only – Do not connect to a 120 V current input

9

Initial startup

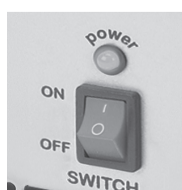

Set the main switch to the ON position
Not applicable to S Series

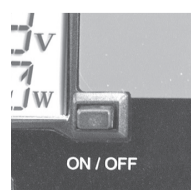

Press the monitor switch



Regular starting cycle: One beep



Fan will start for 1 second



Green light ON